

BLADER S, M, L

USER MANUAL



The luminaire shall be installed by a qualified electrician and wired in accordance with the latest IEE electrical regulations or the national requirements.

Installation Instructions

A. Technical Parameters

Product name	BLADER
Product code	744
Input Voltage	DC 24V
Power	4W - 48W
Power Factor	>0.9
Beam Angle	7°, 15°, 30°, 45°, 60°, 15°x60°, 20x40°, 25°x45°, 120°
Color temperature	SINGLE COLOR, R, G, B, RGB 3in1, RGBW 4in1
Colour rendering index	>70 CRI
Working Environment	-40°C to +50°C
Dimensions	1000x24.5x26.4mm, 1000x33x26,1mm, 1000x38x28.8mm
Net weight	0.7 - 2.0 Kg
Control Mode	On/Off, DMX-512

Installation Instructions

1. According to step 1, fix the bracket on the mounting surface.
2. According to step 2, fix and adjust the bracket as your project needed.

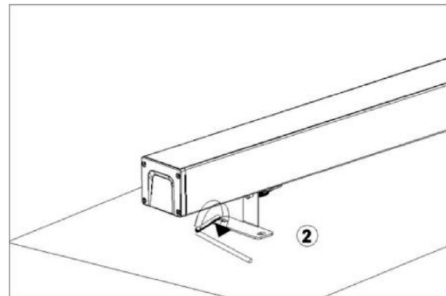
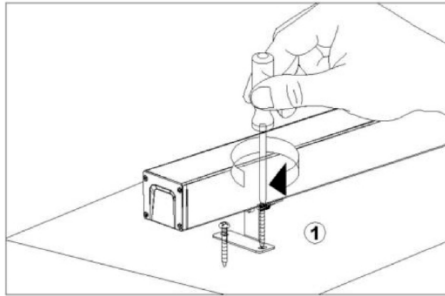

Overall dimensions

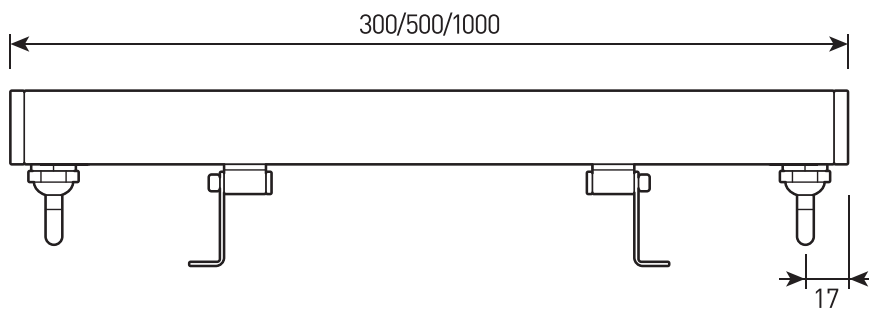

SIZE 1

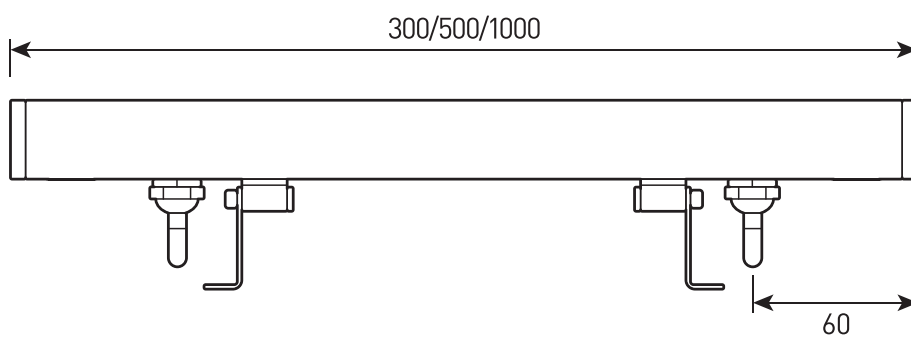
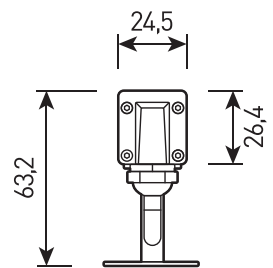

SIZE 2

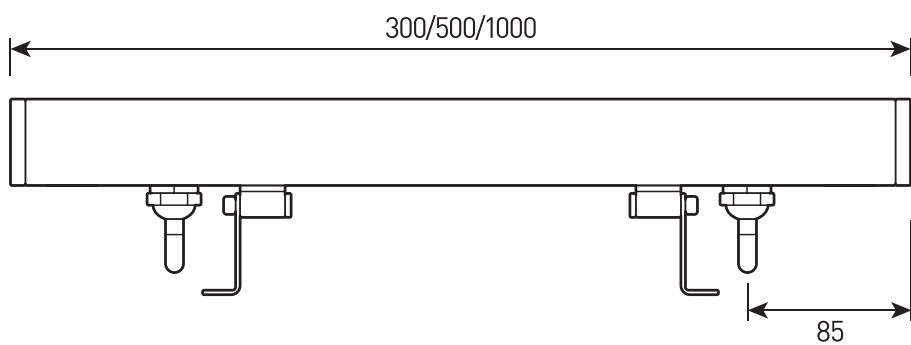
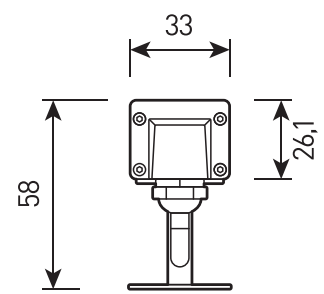

SIZE 3

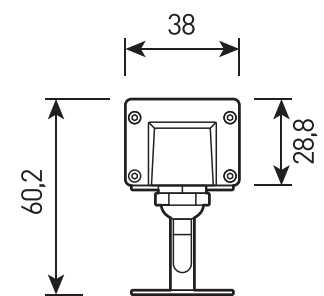

Overall dimensions

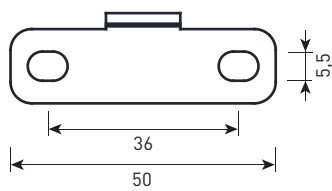
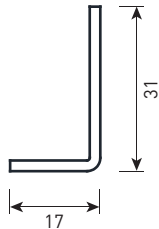
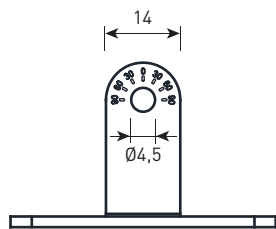

Bracket SIZE 2, 3

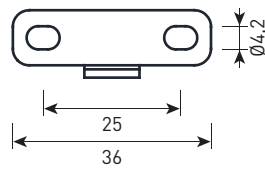
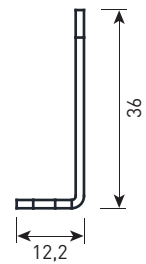
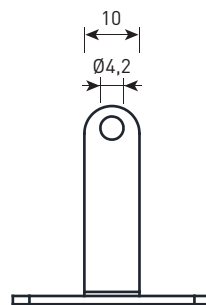

Bracket SIZE 1

Connection diagram

24VDC SINGLE

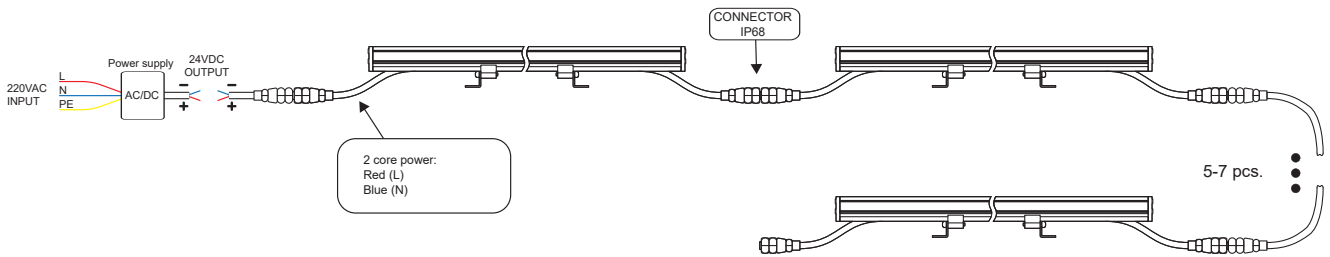

24VDC DMX

