

# BOWLER QUADRO

## USER MANUAL



The luminaire shall be installed by a qualified electrician and wired in accordance with the latest IEE electrical regulations or the national requirements.

# Installation Instructions

---

## Technical Parameters

Product name	BOWLER QUADRO
Product code	695
Input Voltage	AC 220V
Power	12W
Power Factor	>0.9
Beam Angle	120°
Color temperature	SINGLE COLOR
Colour rendering index	>80 CRI
Working Environment	-40°C to +50°C
Dimensions	160x160x1000mm
Net weight	5 Kg
Control Mode	On/Off

## Installation Instructions

1. Drill holes in the mounting surface.
2. Install the anchors in the holes.
3. Fix the embedded part.
4. Connect the power supply to the luminaire.
5. Fasten the lamp to the embedded part with screws.
6. Complete.

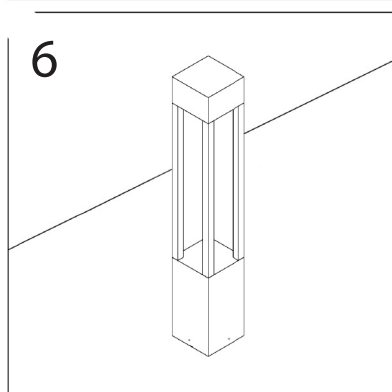
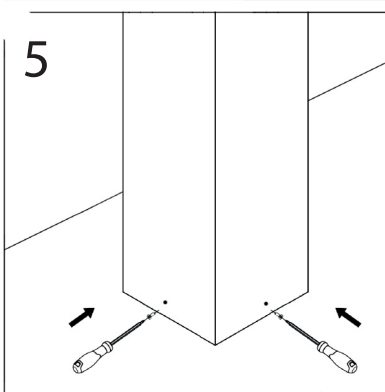
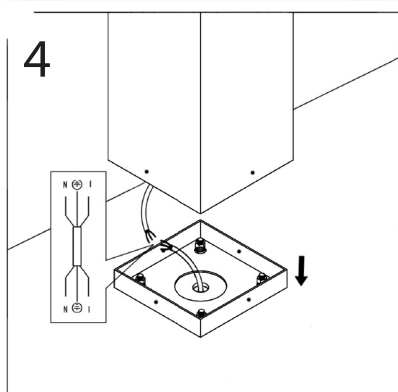
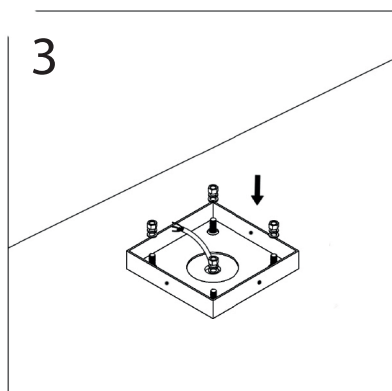
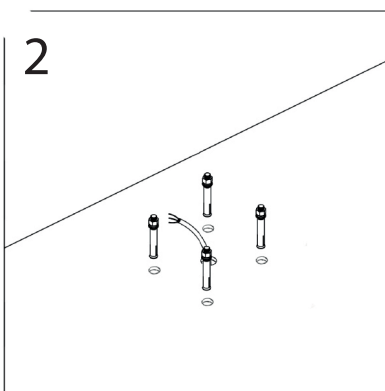
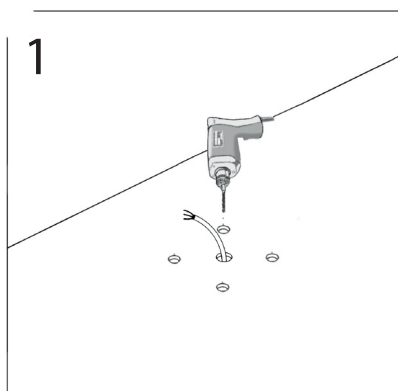

## Installation Instructions

