

BRUMI

USER MANUAL



The luminaire shall be installed by a qualified electrician and wired in accordance with the latest IEE electrical regulations or the national requirements.

Installation Instructions

Product name: BRUMI
Product code: 695
Housing: Pressure die-cast aluminum. Anti-ultraviolet pure polyester powder painting surface.
Housing Color: Black, Grey, RAL
Beam Angle: 80°
Color Temperature: 3000K, 4000K, 6000K
Control System: On/Off, 0-10V, DALI
Input Voltage: 220 V
Protection Class: Class I
Protection Rating: IP65
Weight: 5.1 – 5.8 kg

Installation Instructions

1. Loosen the screws on the luminaire body to detach the base flange.
2. Thread the power cable through the flange. Install and secure the flange to the anchor.
3. Connect the power cable to the luminaire.
4. Install the luminaire body. Tighten the screws.

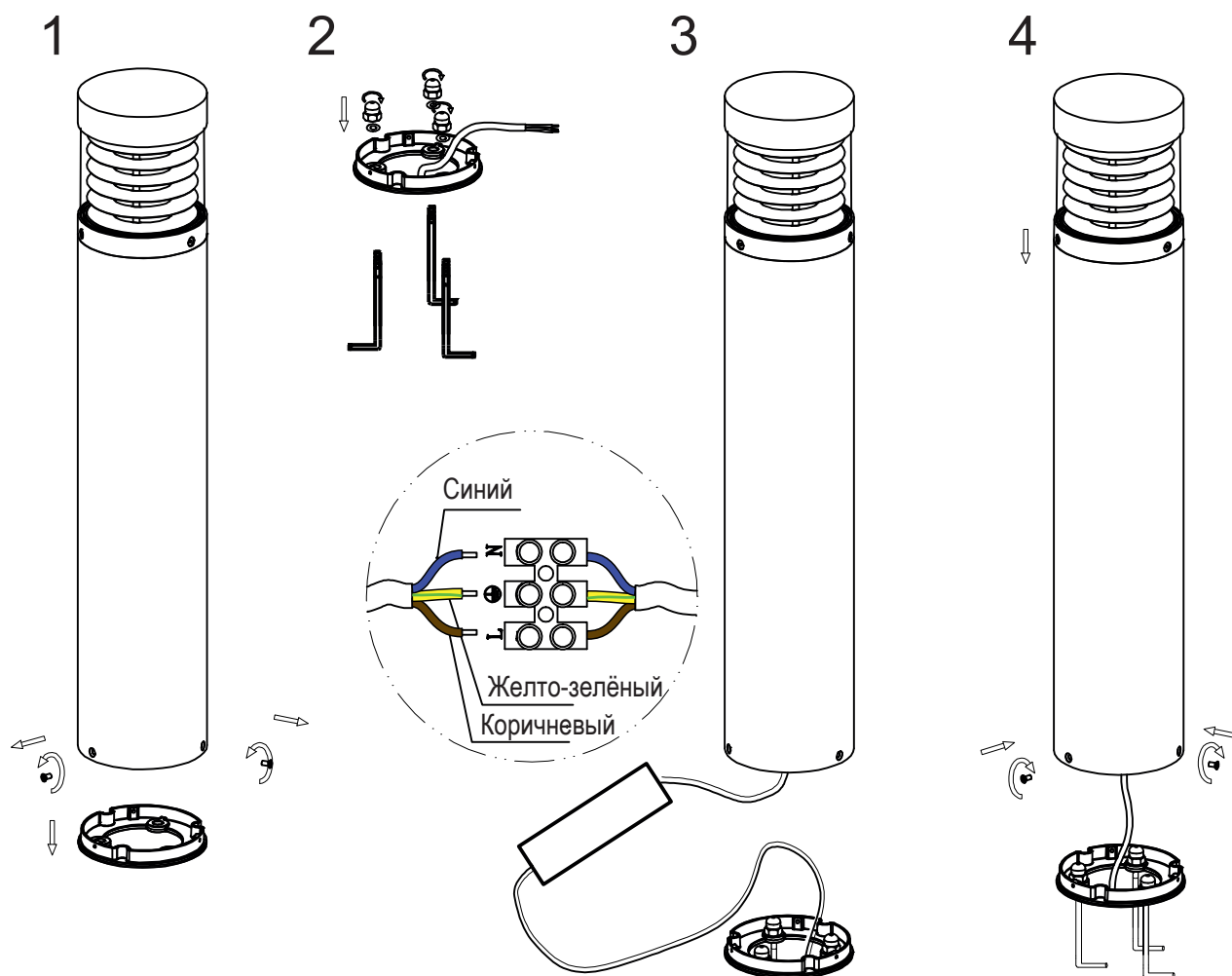

Overall dimensions

