

CRUZ

USER MANUAL



The luminaire shall be installed by a qualified electrician and wired in accordance with the latest IEE electrical regulations or the national requirements.

Installation Instructions

Technical Parameters

Product name	CRUZ
Product code	783
Input Voltage	DC 12V, DC 24V, AC 220V
Power	3.5 - 16W
Power Factor	>0.9
Beam Angle	8°, 12.5°, 20°, 30°, 45°, 60°
Color temperature	SINGLE COLOR, RGB
Working Environment	-40°C to +50°C
Dimensions	Ø110x68.6, Ø130x83.6mm, Ø150x140.2
Net weight	0.85 - 1.5 Kg
Control Mode	On/Off, DMX-512

Installation Instructions

1. Laying 20cm or much deeper water-seepage sand in the mounting hole before installing the mounting cup.
2. Install the mounting cup.
3. Install the luminaire body in the mounting cup. Connect the wires. Fix the mounting cup and the luminaire with screws.

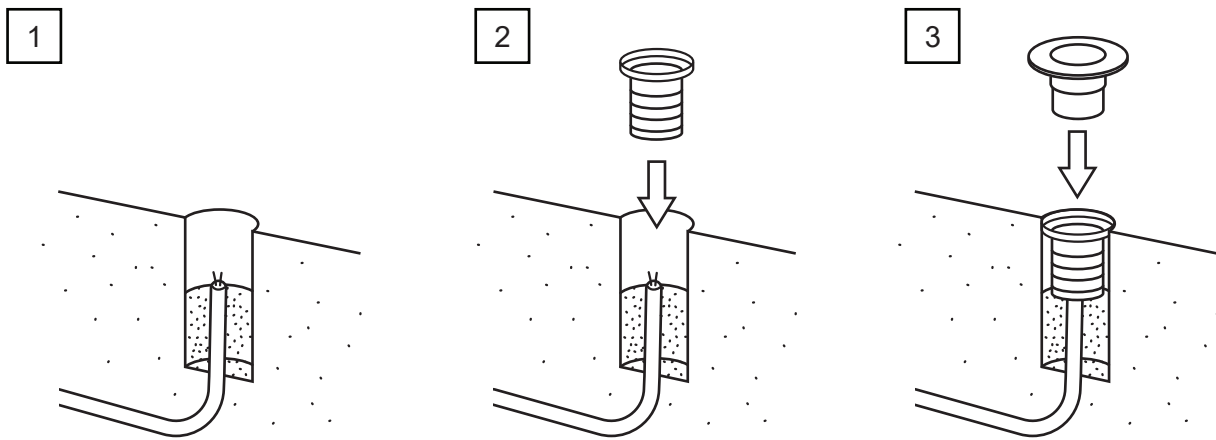

Notes

The mounting cup must get reliable connection with the lamp body, any screws in the lamps should not be arbitrarily loosed.

There is no special requirement on the installation depth.

Remarks for the cables

When you get the fixture, please check and find the relative version and confirm its Color Temperature, Electrical class, the cable out.

Overall dimensions

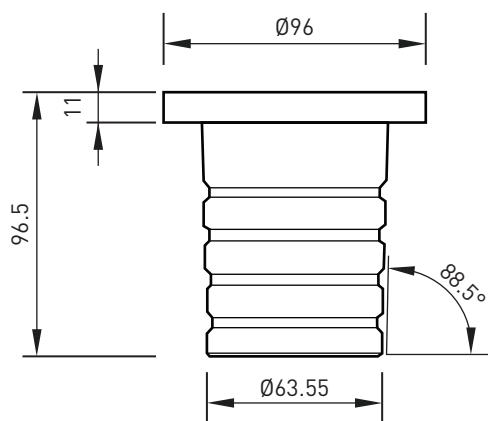

CRUZ S

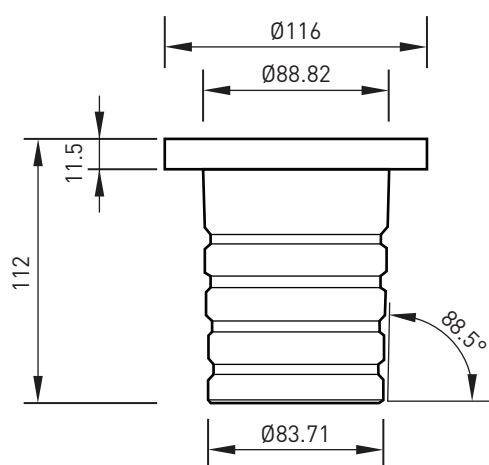
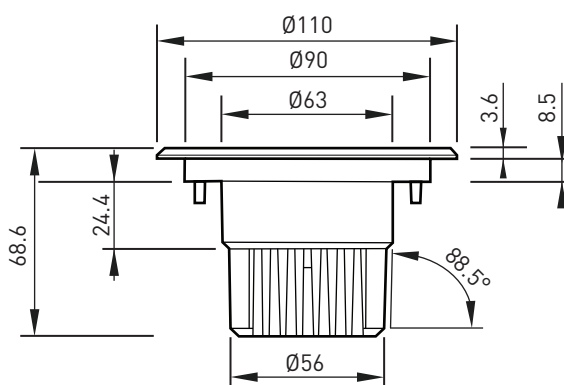

CRUZ M

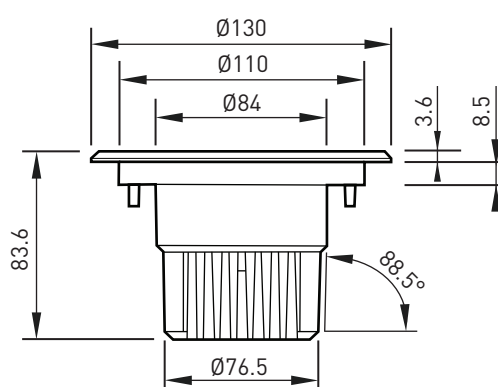

Overall dimensions

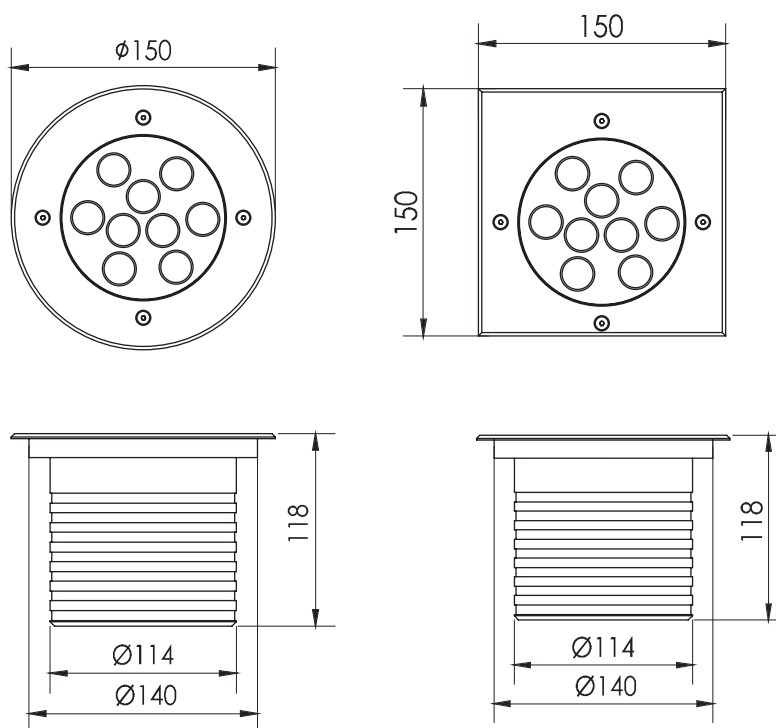

CRUZ L