

# ORIOIS TOP

## USER MANUAL



The luminaire shall be installed by a qualified electrician and wired in accordance with the latest IEE electrical regulations or the national requirements.

## Technical Parameters

---

Housing:	Pressure die-cast aluminum alloy with polyester powder paint
Housing Color:	Black, Grey, RAL
Beam Angle:	15°, 25°, 40°, 60°, 90°
Color Temperature:	2700K, 3000K, 4000K, 5000K, 6000K, Red, Green, Blue, RGB, RGBW
Control System:	On/Off, DMX-512, 1-10V, DALI
Input Voltage:	24 V, 220 V
Protection Class:	Class I, Class III
Protection Rating:	IP66
Weight:	1.5 – 4.2 kg

## Installation Instructions



Before connecting and servicing the lamp, make sure that the power is turned off and there is no voltage in the wires.

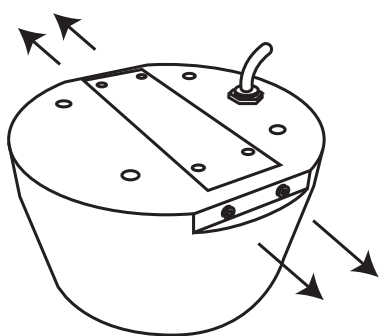

1. Loosen the hexagonal screws to release the mounting plate

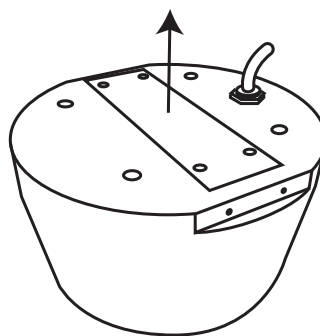

2. Detach the mounting plate from the light

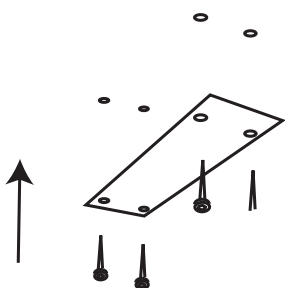

3. Fix the mounting plate to the ceiling

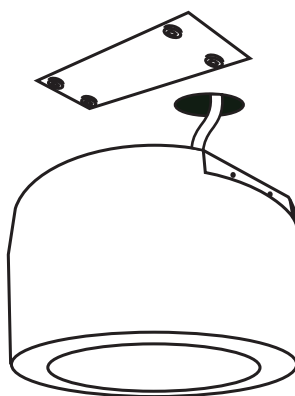

4. Connect the power cable

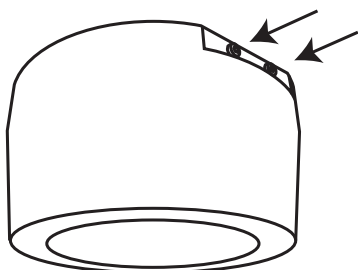

5. Install the light on the mounting plate, tighten the screws

## Overall dimensions

ORISOLIS  
TOP S

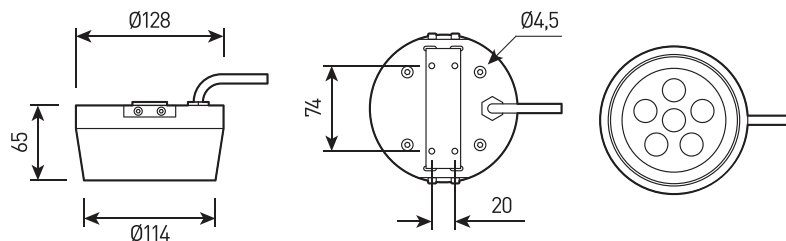

ORISOLIS  
TOP M

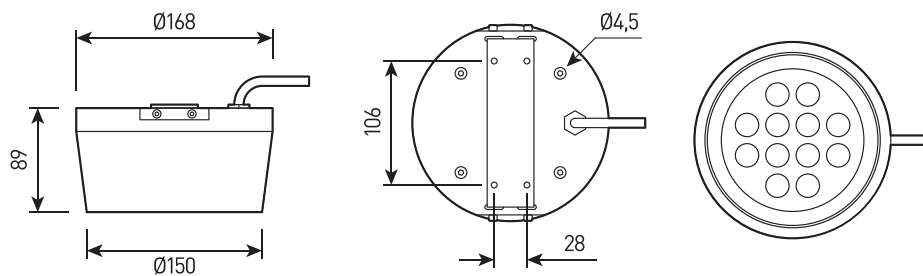

ORISOLIS  
TOP L

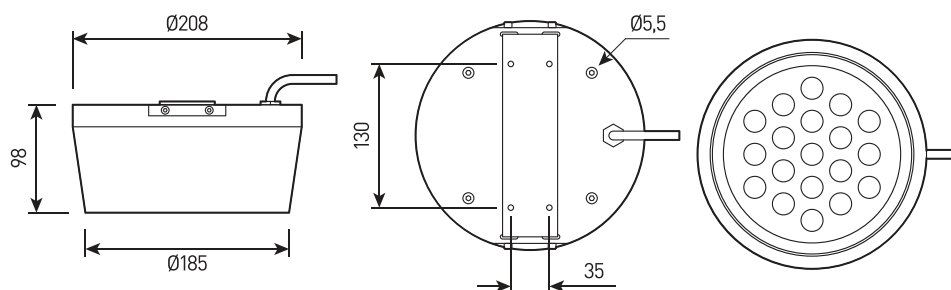

ORISOLIS  
TOP XL

