

SCOUT

USER MANUAL



The luminaire shall be installed by a qualified electrician and wired in accordance with the latest IEE electrical regulations or the national requirements.

Installation Instructions

Technical Parameters

Product name	SCOUT
Product code	700
Input Voltage	AC 220V
Power	15 - 25W
Power Factor	>0.9
Beam Angle	120°
Color temperature	SINGLE COLOR
Colour rendering index	>80 CRI
Working Environment	-40°C to +50°C
Dimensions	Ø172x400mm, Ø172x600mm, Ø172x900mm
Net weight	4.2 - 6.7 Kg
Control Mode	On/Off, DALI

Installation Instructions

1. Unscrew the screws to release the base plate.
2. Prepare the mounting location. Pass the cable through the center of the base plate. Attach the base plate to the mounting surface.
3. Connect the cable to the junction box.
4. Install the luminaire housing on the plastic plate.

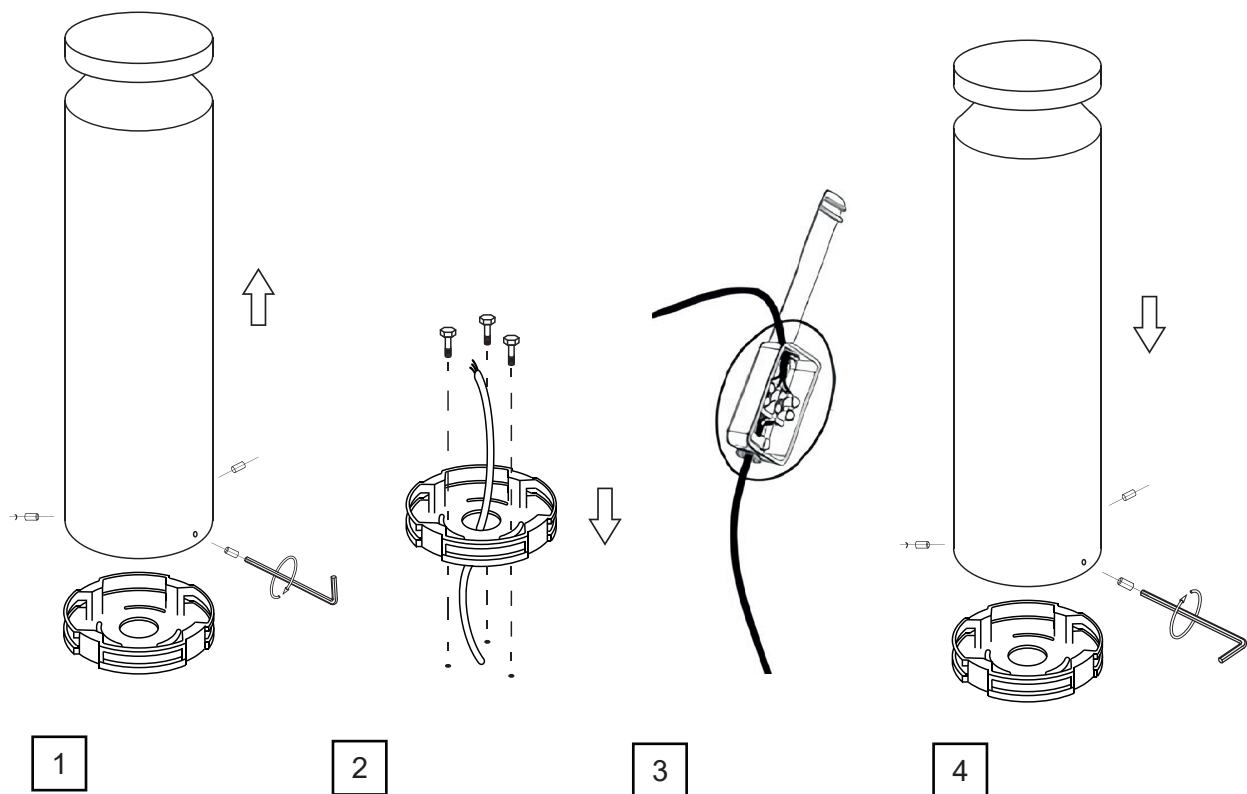

Installation Instructions

Example wiring diagram

AC220V

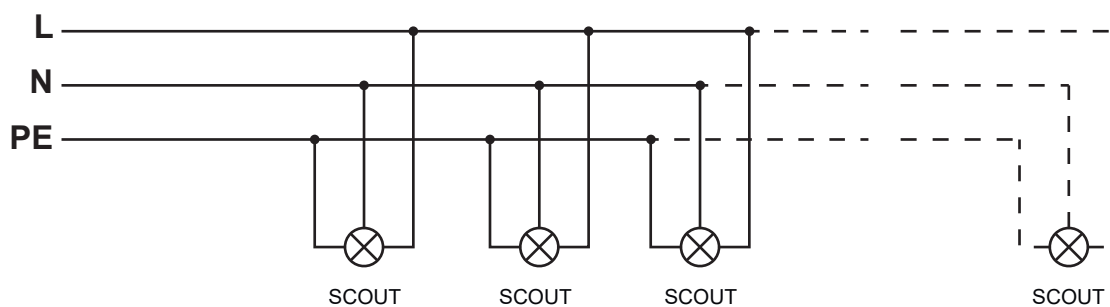

Overall dimensions

