

TRIMO

USER MANUAL



The luminaire shall be installed by a qualified electrician and wired in accordance with the latest IEE electrical regulations or the national requirements.

Installation Instructions

A. Technical Parameters

Product name	TRIMO
Product code	692
Input Voltage	AC 220 V
Power	15-120 W
Power Factor	>0.9
Beam Angle	120°
Color temperature	SINGLE COLOR
Colour rendering index	>80 CRI
Working Environment	-40°C to +50°C
Dimensions	Ø168×2500mm, Ø168×3500mm, Ø168×4500mm, Ø118×800mm, Ø118×1000mm
Net weight	5-50 Kg
Control Mode	On/Off, 0 - 10V, DALI

Installation Instructions

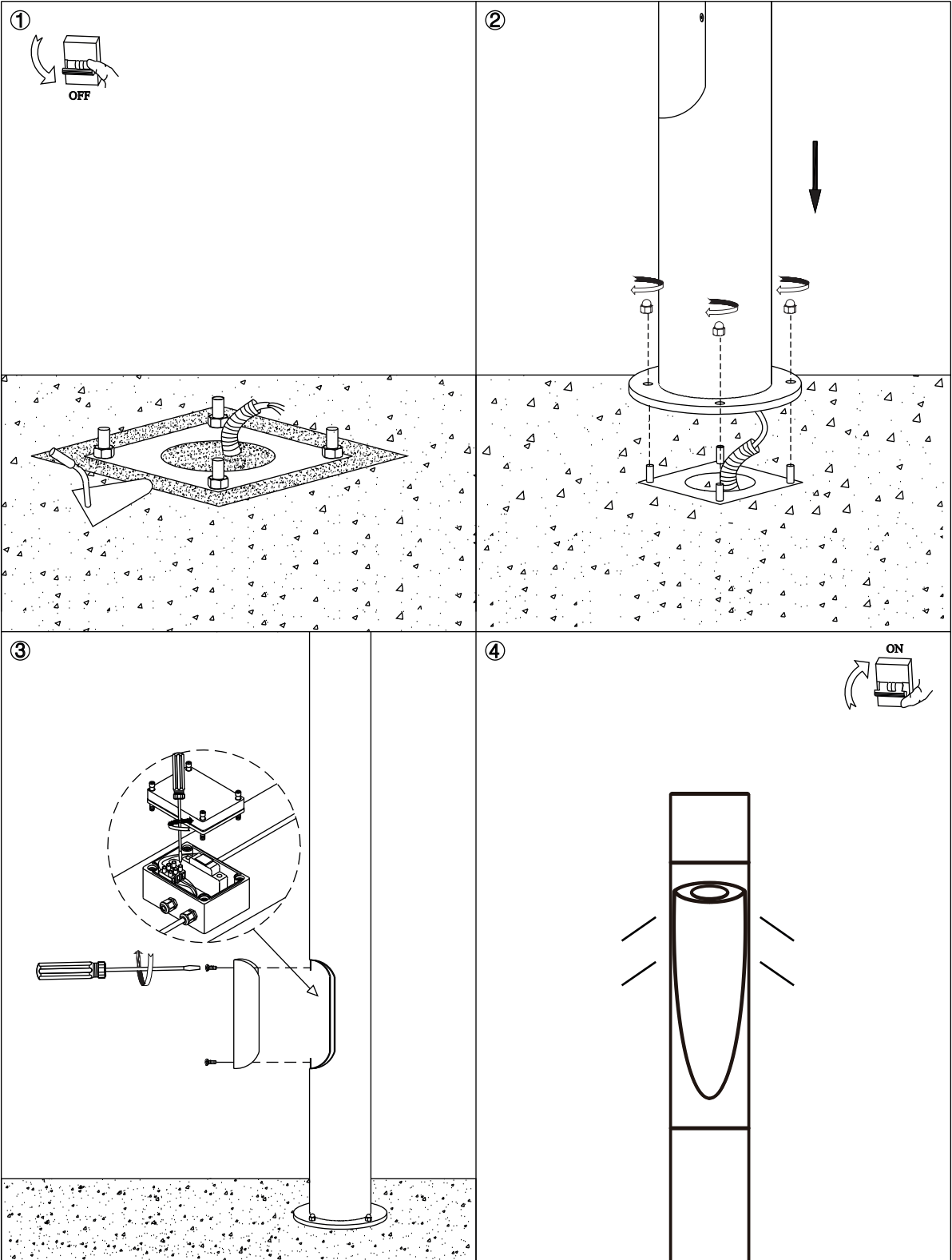

Overall dimensions

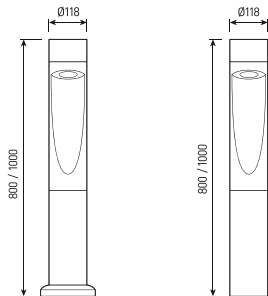

TRIMO 800mm / 1000mm

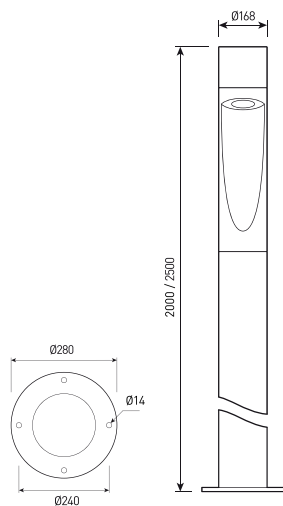

TRIMO 1

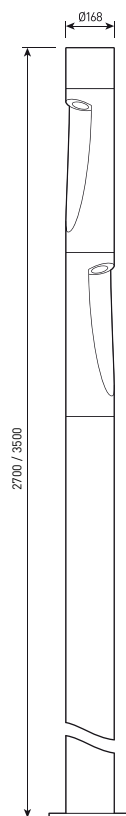

TRIMO 2

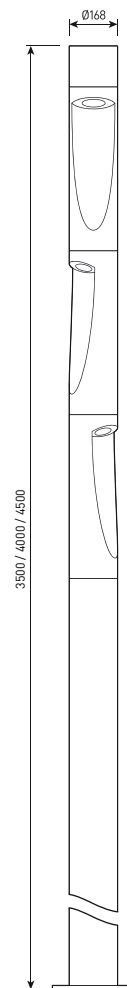

TRIMO 3